

# ELLA JOHNSON MEMORIAL PUBLIC LIBRARY DISTRICT





DOWNTOWN COMMERCIAL DISTRICT

FUTURE VILLAGE HALL & POLICE STATION

NORTH STATE ROAD

HAMPSHIRE CAMPUS LIBRARY

WINDHAM LANE

FUTURE PUBLIC WORKS BUILDING

TOWN PLACE ROAD

HAMPSHIRE  
CAMPUS  
*Aerial Campus View*

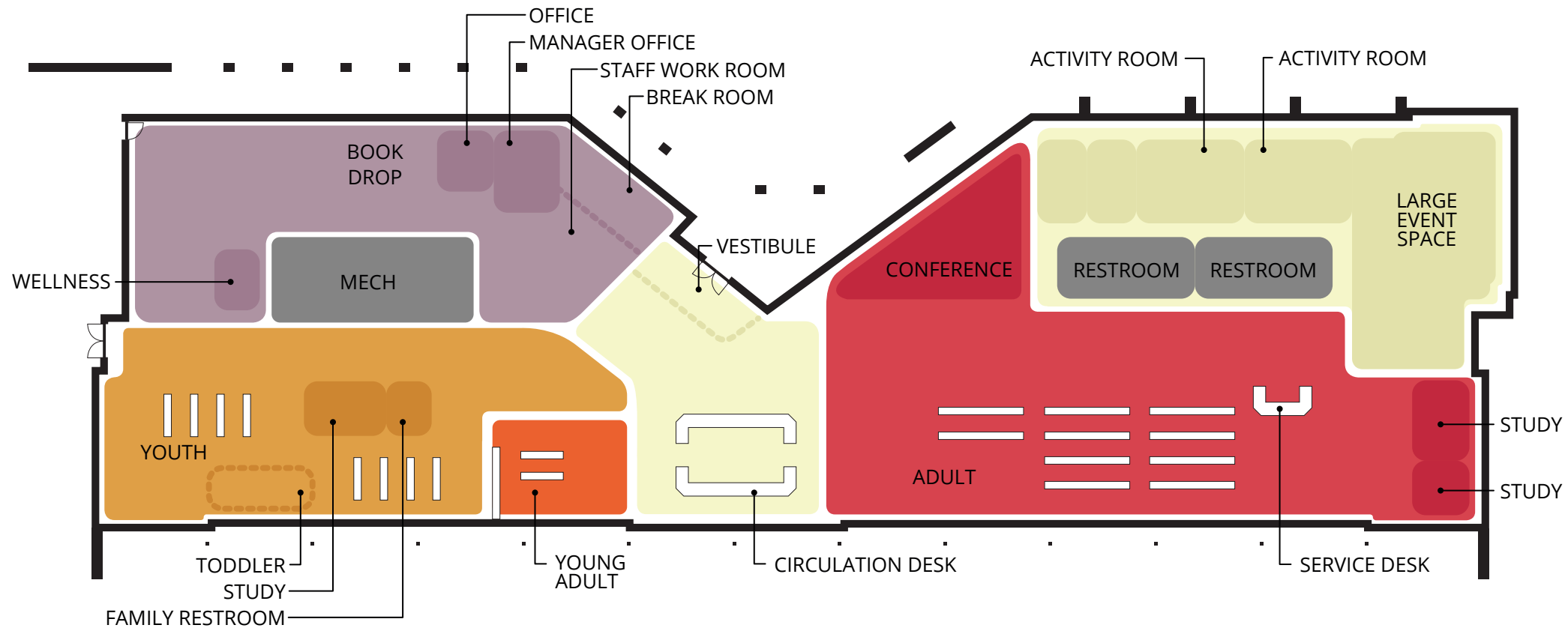

The two new branch libraries for the Ella Johnson Memorial Public Library District, located in Hampshire and Pingree Grove, are designed to distribute resources and foster increased learning and growth for all community members. While complimentary in style, each building uniquely responds to the character and needs of its respective site. They are modern, yet familiar, offering a fresh take on the local Midwestern vernacular.

A key feature of both libraries is the prominence of the entrances, marked by large, welcoming public spaces. These entries serve not only as functional shelters from weather but as visual focal points, making the library a destination. They create an inviting threshold between the outside world and the wealth of knowledge inside.

Inside, the libraries emphasize openness and lightness. Expansive, open floor plans create a flow that ignites interest in the library through engaging and responsive visual and intuitive communication techniques. The community porches reflect the communal spirit of the Midwest, perfect for sitting down with a good book. At the Hampshire Campus, the porch offers respite and connection to new community gardens and outdoor youth spaces. Meanwhile, the porch at the Pingree Grove Branch connects visitors to nature, offering views of the wetlands and ponds.

Strategically placed windows bring in natural light, enhancing the sense of space while minimizing glare. This airy design fosters a feeling of calm and focus—ideal for reading, studying, and community gatherings. The interiors are flexible, accommodating both quiet individual activities and larger community events, with spaces designed for various ages and uses. Administrative areas are designed to foster an organizational culture that empowers staff and maximizes the library's effectiveness.

Together, these libraries represent a shared commitment to education, community, and sustainability, offering modern, accessible spaces that both respect and enhance their local contexts.

# HAMPSHIRE CAMPUS



PINGREE GROVE MUNICIPAL CENTER

PARKING FOR 110 CARS

PINGREE GROVE CAMPUS LIBRARY

COMMUNITY GARDENS

WESTER BOULEVARD

REINKING ROAD

PINGREE GROVE  
CAMPUS  
Aerial View

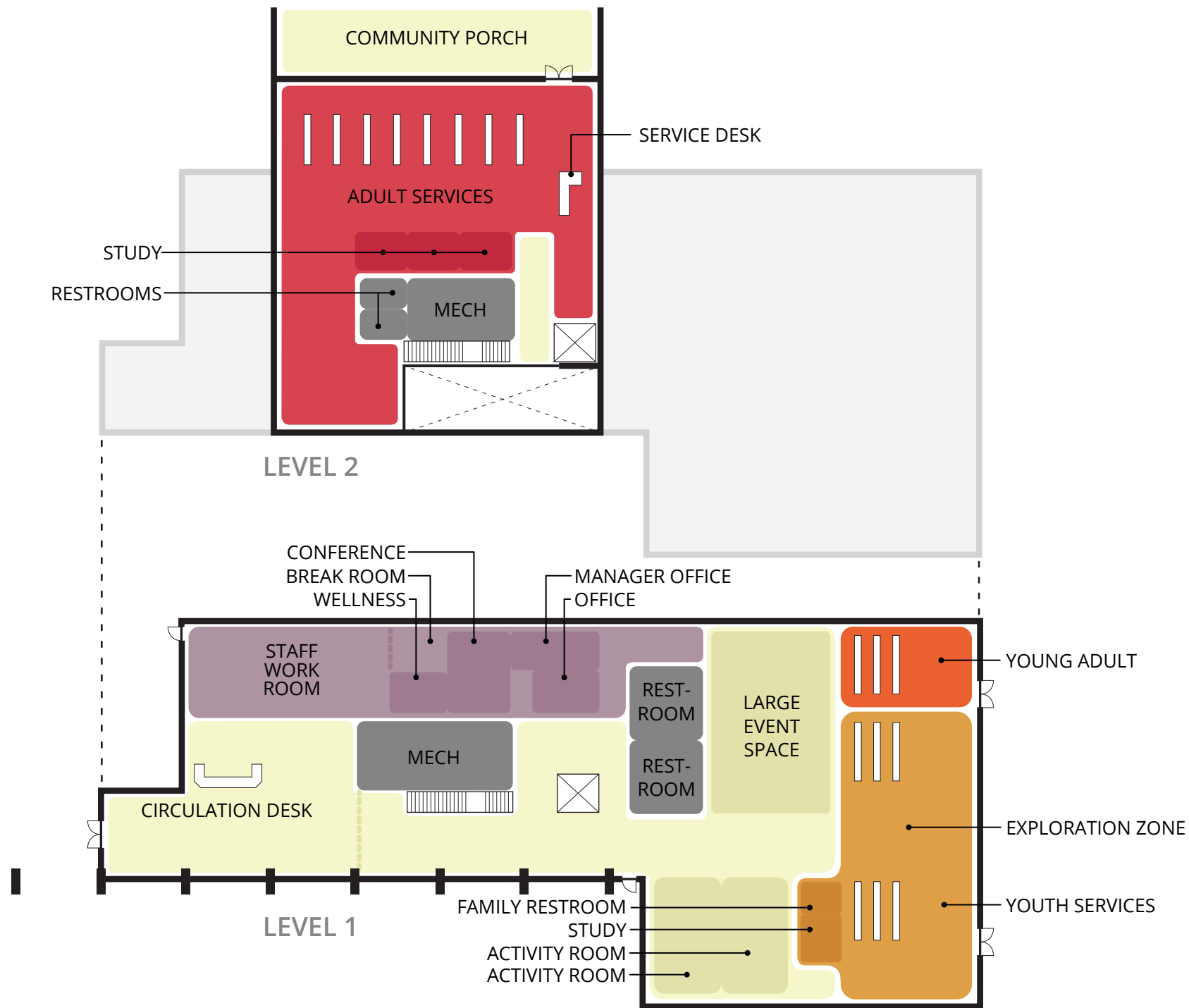

The two new branch libraries for the Ella Johnson Memorial Public Library District, located in Hampshire and Pingree Grove, are designed to distribute resources and foster increased learning and growth for all community members. While complimentary in style, each building uniquely responds to the character and needs of its respective site. They are modern, yet familiar, offering a fresh take on the local Midwestern vernacular.

A key feature of both libraries is the prominence of the entrances, marked by large, welcoming public spaces. These entries serve not only as functional shelters from weather but as visual focal points, making the library a destination. They create an inviting threshold between the outside world and the wealth of knowledge inside.

Inside, the libraries emphasize openness and lightness. Expansive, open floor plans create a flow that ignites interest in the library through engaging and responsive visual and intuitive communication techniques. The community porches reflect the communal spirit of the Midwest, perfect for sitting down with a good book. At the Hampshire Campus, the porch offers respite and connection to new community gardens and outdoor youth spaces. Meanwhile, the porch at the Pingree Grove Branch connects visitors to nature, offering views of the wetlands and ponds.

Strategically placed windows bring in natural light, enhancing the sense of space while minimizing glare. This airy design fosters a feeling of calm and focus—ideal for reading, studying, and community gatherings. The interiors are flexible, accommodating both quiet individual activities and larger community events, with spaces designed for various ages and uses. Administrative areas are designed to foster an organizational culture that empowers staff and maximizes the library's effectiveness.

Together, these libraries represent a shared commitment to education, community, and sustainability, offering modern, accessible spaces that both respect and enhance their local contexts.

## PINGREE GROVE CAMPUS



PINGREE GROVE  
CAMPUS  
Entry View



**PINGREE GROVE  
CAMPUS**  
*View from Wester Blvd*



ELLA JOHNSON  
MEMORIAL PUBLIC LIBRARY DISTRICT

HAMPSHIRE  
CAMPUS  
Entry View





**HAMPSHIRE  
CAMPUS**  
*Garden View*